

Step 1:

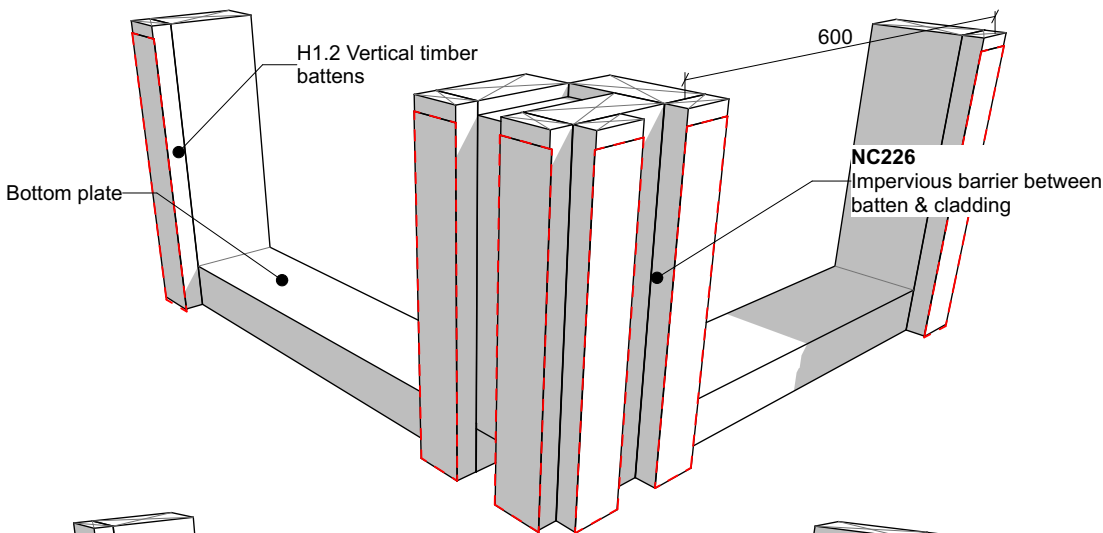

Step 2:

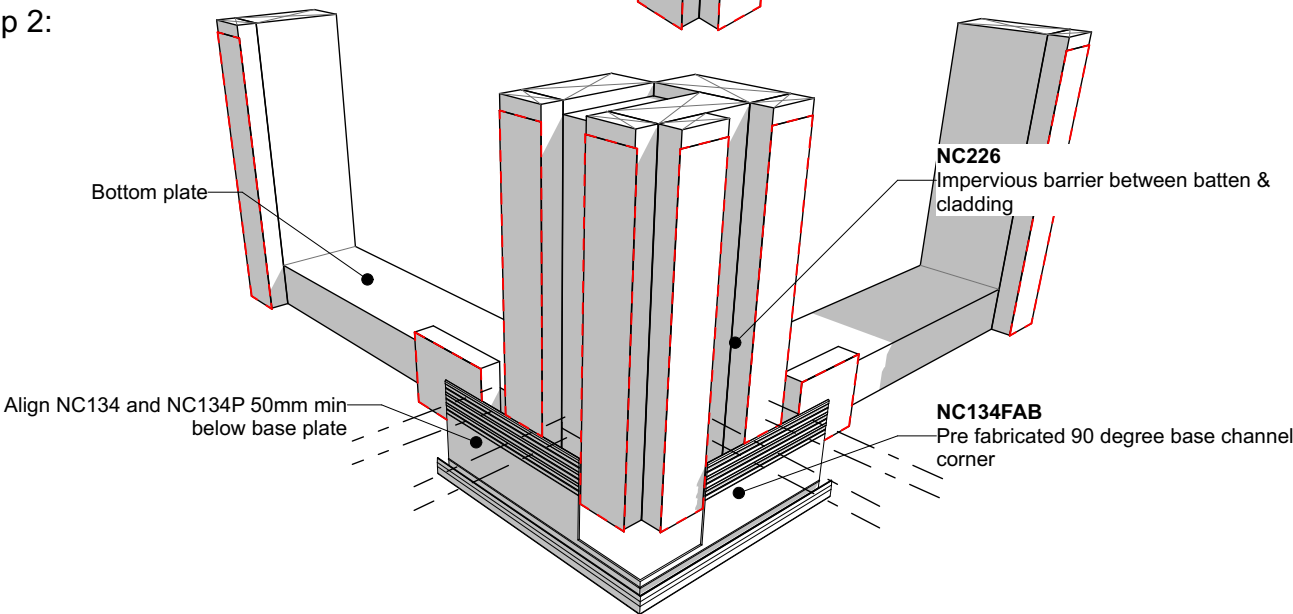

Step 3:

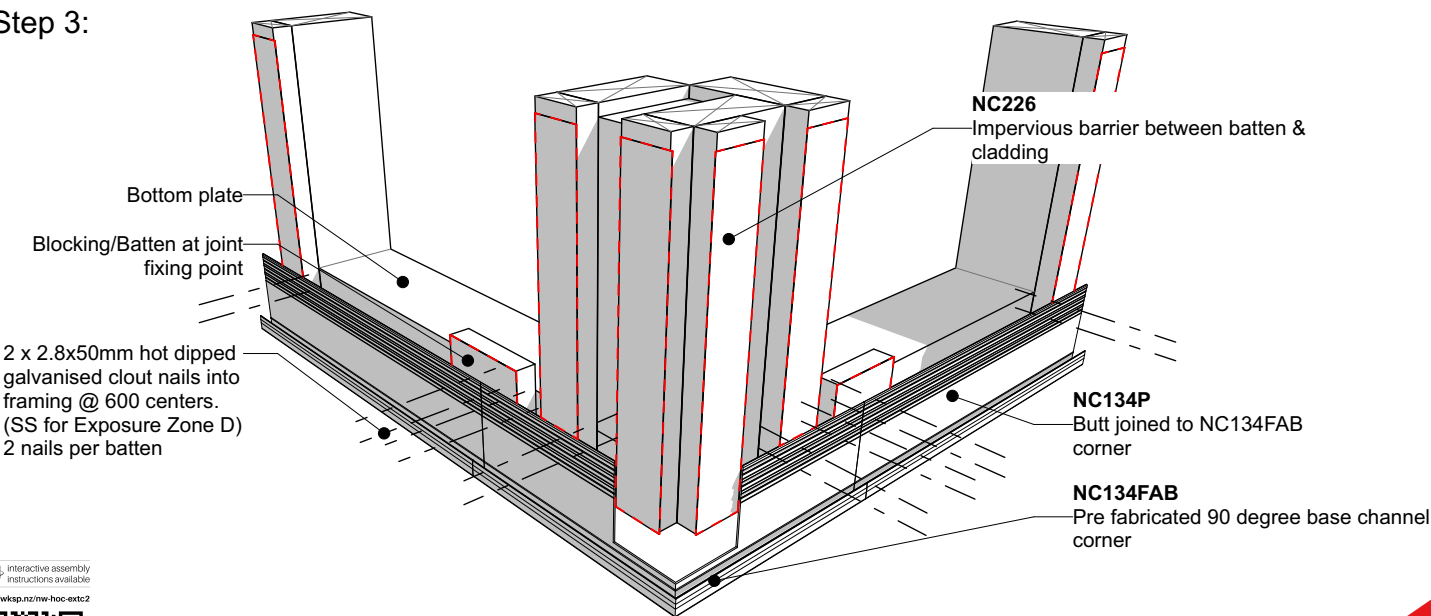

Interactive assembly
instructions available
<http://wkap.nz/nw-hoc-extc2>



Get WORKINGSPEC from
Apple App Store/Google Play



	Nu-Wall cladding horizontal on cavity		NW-HOC-008.02	
	Pre-Fabricated 90 deg base channel corner		Drawn by: Nu-Wall	Date: 25/02/2025
	© 2021 copyright in this document is the property of Nu-Wall Aluminium Cladding Limited. All rights reserved. Nu-Wall is a registered trademark of Aluminium Product Brands NZ Limited		Checked by: RL, GT	Scale: NTS