

Step 1:

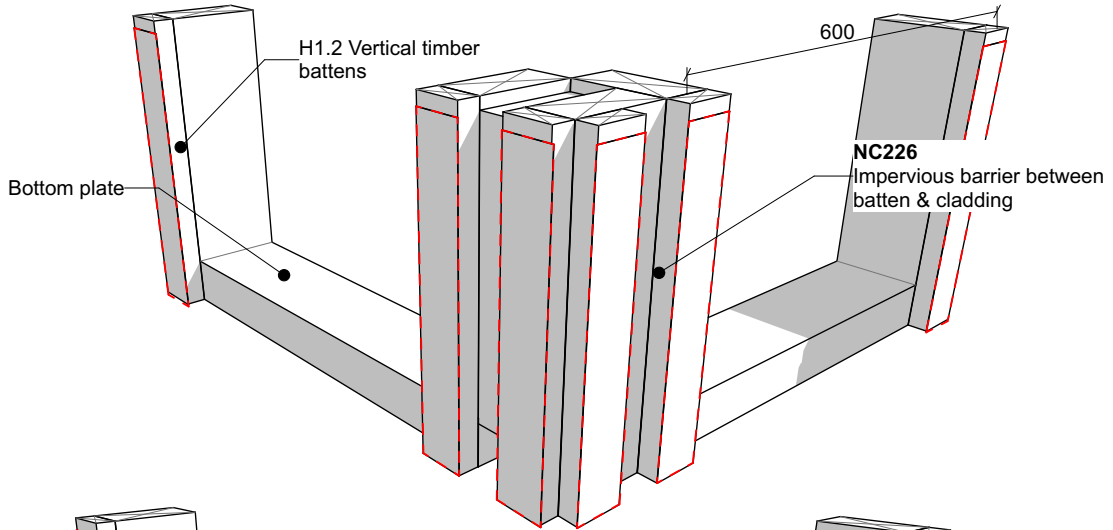

Step 2:

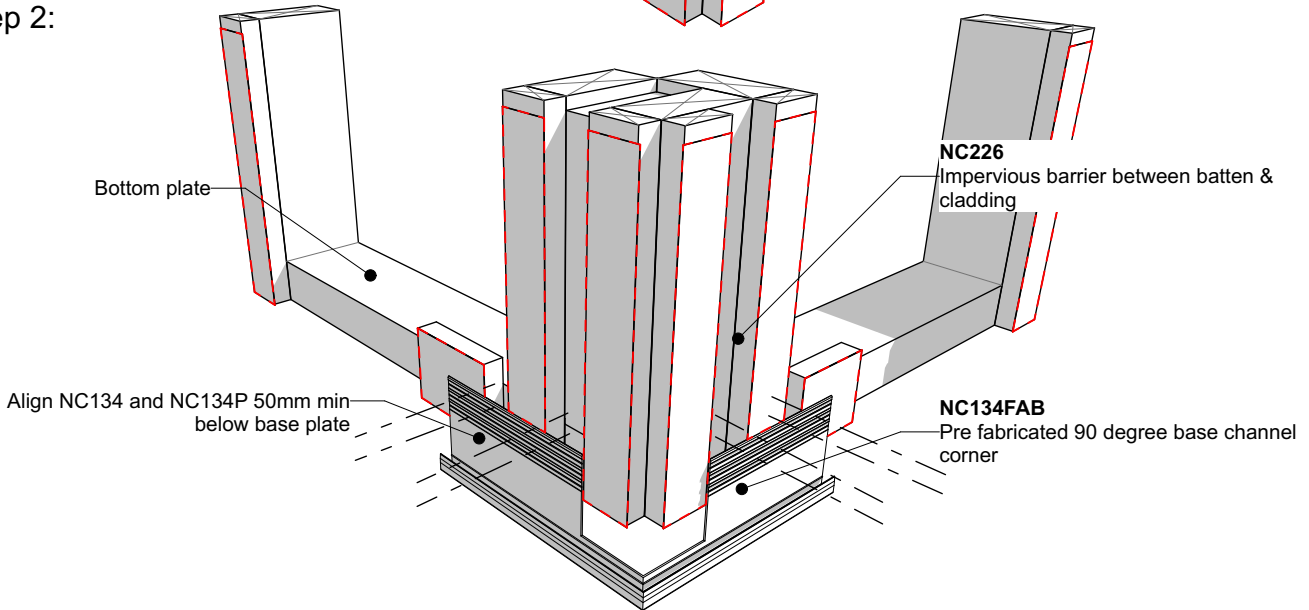

Step 3:

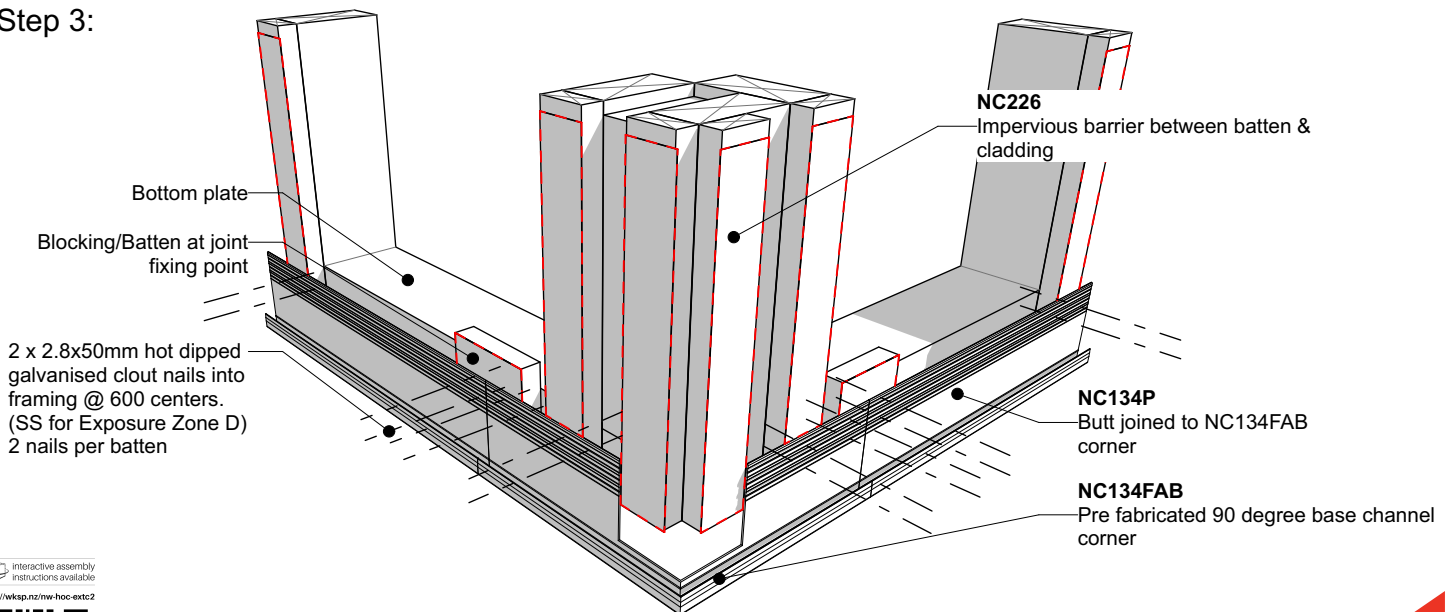

Interactive assembly instructions available

<http://wvsp.nz/nw-hoc-extc2>



Get WORKINGSPEC from Apple App Store/Google Play



BRANZ Appraised
Appraisal No. 550 [2019]

Nu-Wall cladding horizontal on cavity
Pre-Fabricated 90 deg base channel corner

NW-HOC-008.02

Drawn by: Nu-Wall

Date: 19/9/2024

Checked by: RL, GT

Scale: NTS

© 2021 copyright in this document is the property of Nu-Wall Aluminium Cladding Limited. All rights reserved. Nu-Wall is a registered trademark of Aluminium Product Brands NZ Limited